

Made in Taiwan

OL002
Installation Instruction

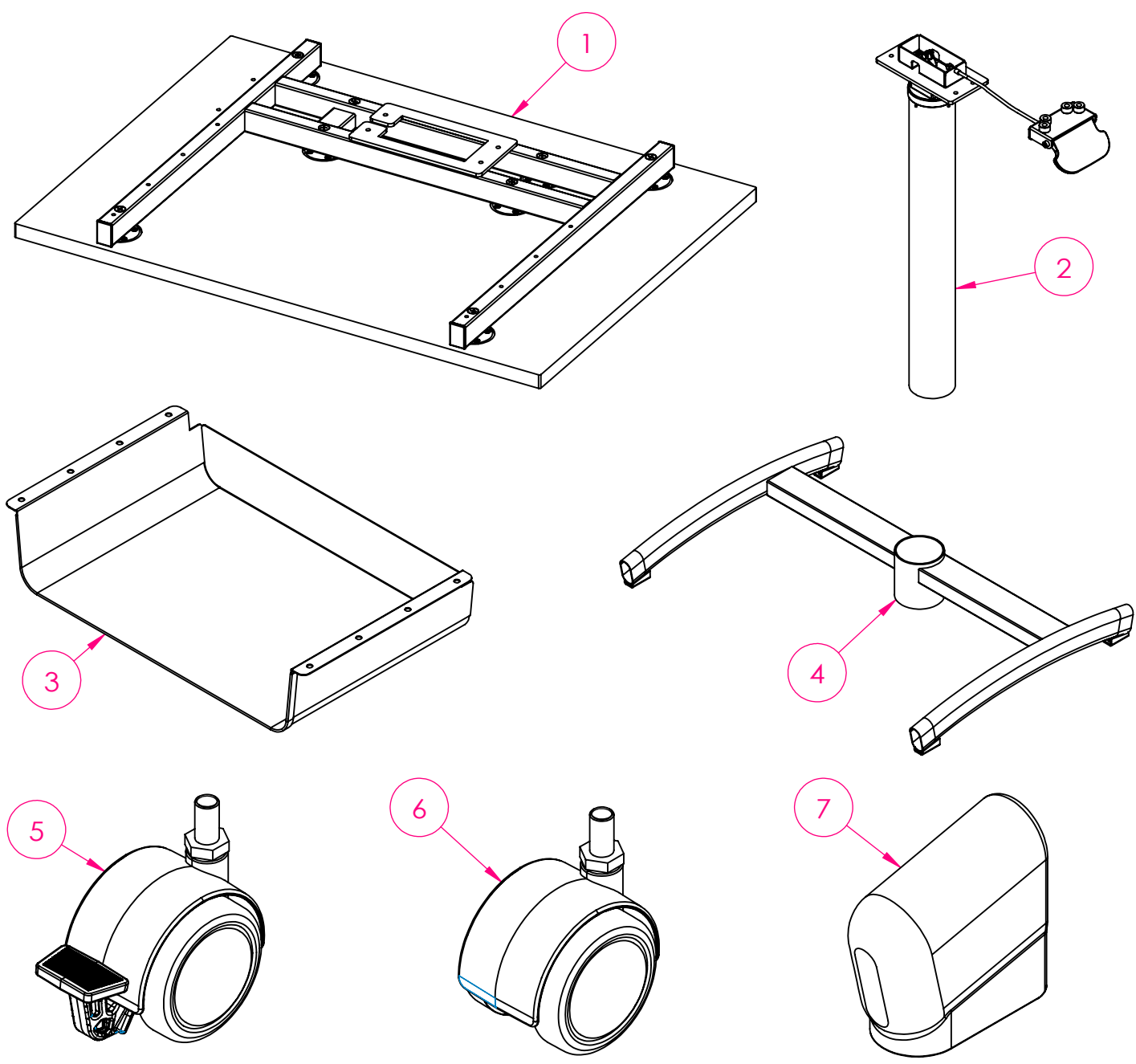

主體物件 Product Component		
編號 Item No.	品名 Description	數量 Qty.
1	桌面 Desk	1
2	立柱 Column	1
3	抽屜 Drawer	1
4	底座 Base	1
5	剎車輪 Locking Casters	2
6	活動輪 Casters	2
7	橡膠管塞 Rubber Tube Caps	4

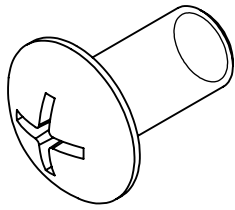

A-1

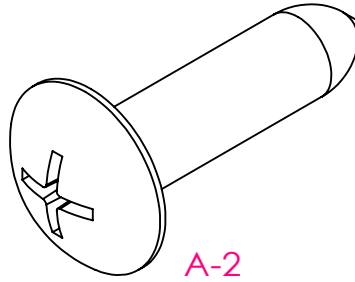

A-2

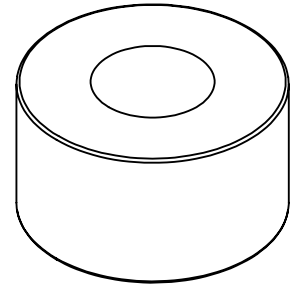

A-3

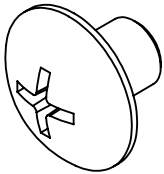

B-1

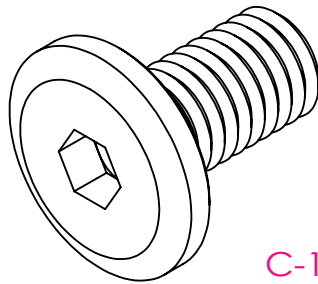

C-1

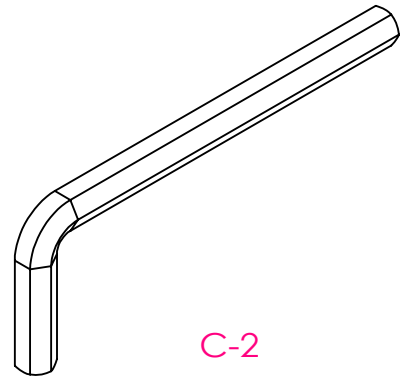

C-2

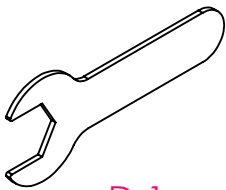

D-1

零件編號 Part No.	零件名稱 Part Name	零件數量 Qty
A-1	M6*12mm 螺絲 M6*12mm Screws	4
A-2	Ø 1/4"*25mm 自攻螺絲 Ø 1/4"*25mm Self-Drilling Screws for Wood	4
A-3	10mm 塑膠墊片 10mm Spacer	4
B-1	M5*6mm 螺絲 M5*6mm Screws	8
C-1	M8*15mm 內六角螺絲 M8*15mm Screws	4
C-2	5號六角扳手 5# Allen key	1
D-1	13號開口扳手 13# Allen Wrench	1

步驟一：將②<立柱>對準①<桌面>上的預留孔，鎖入<A-1>螺絲鎖緊固定

Step 1 : Align ② <Column> with the reserved holes on ① <Desk>, Screw A-1 <M6*12mm Screw>.

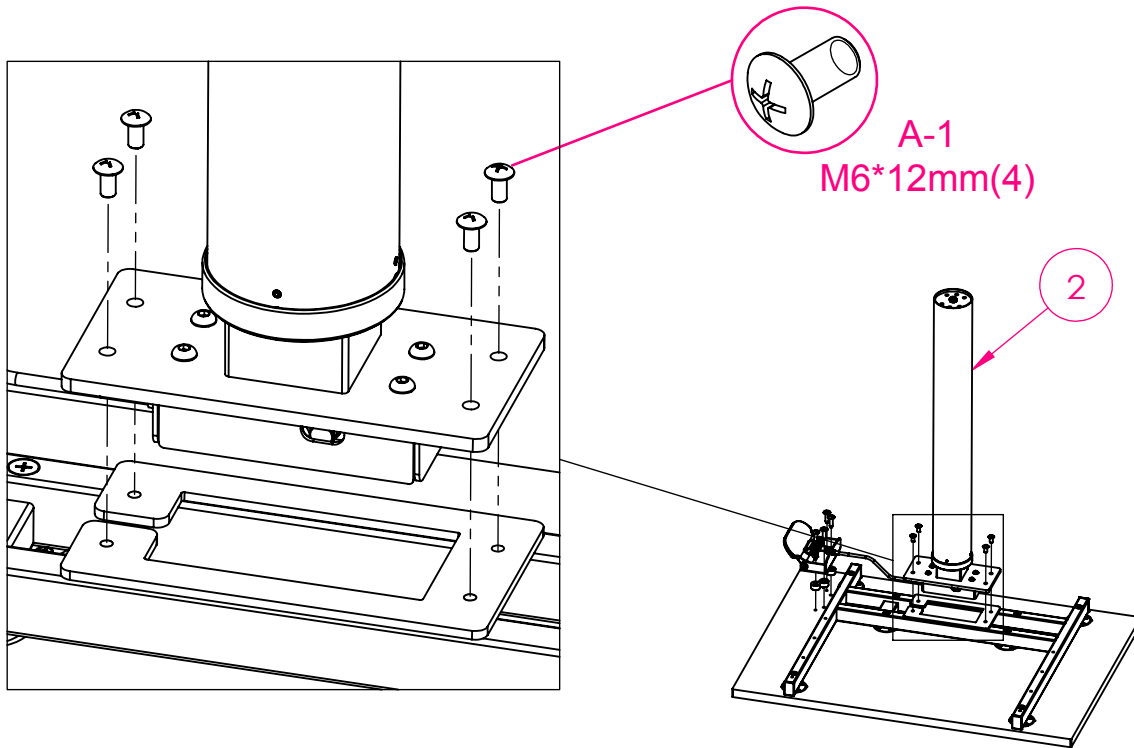

步驟二：壓板下方墊 A-3<10mm塑膠墊片>後對準①<桌面>的預留孔，鎖入<A-2>螺絲鎖緊固定。

Step 2 : Put A-3<10mm Spacer> between handle and ① <Desk>, Screw A-2 <∅ 1/4" * 25mm Self-Drilling Screws for Wood>.

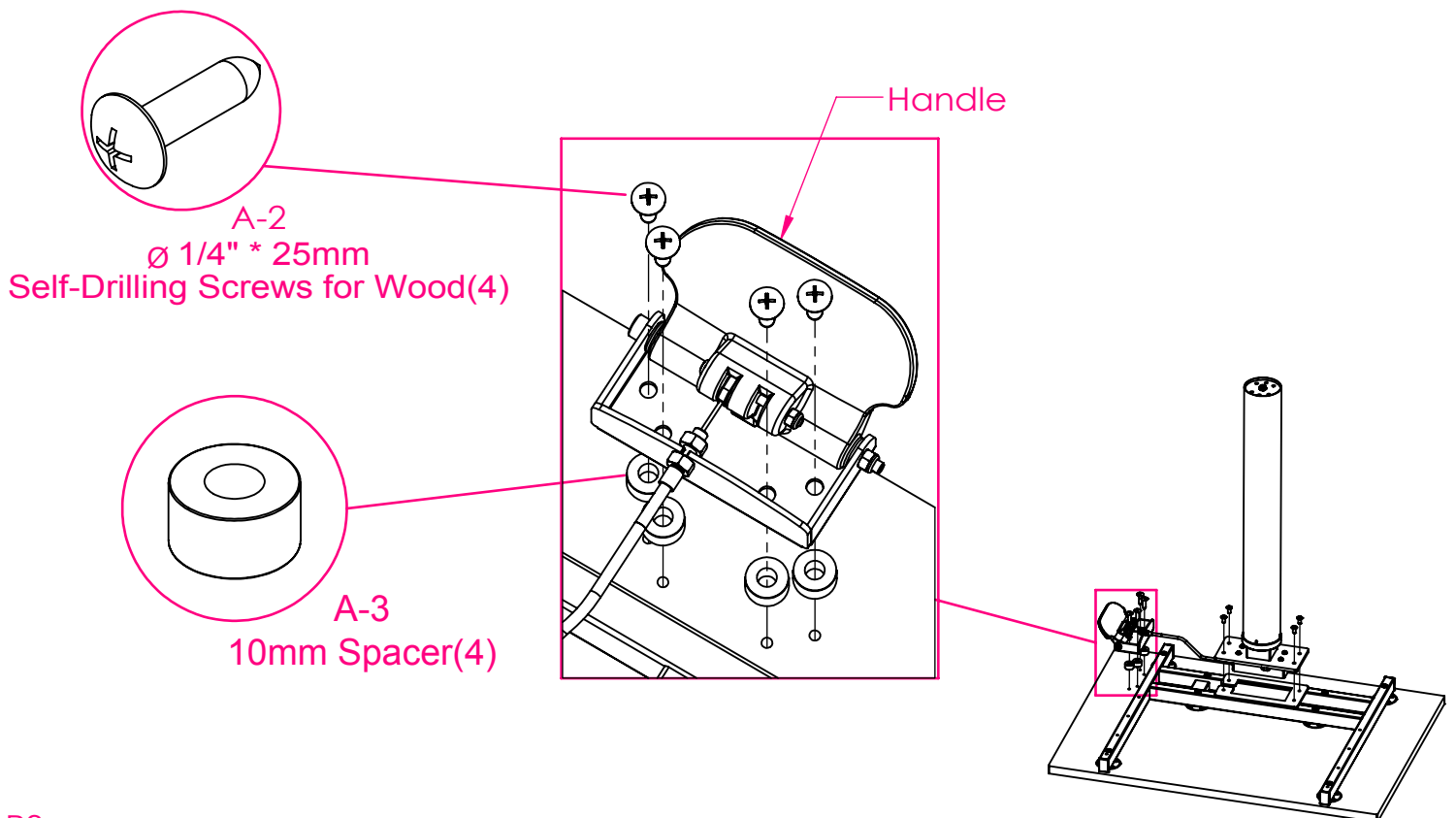

步驟三：將③<抽屜>對準①<桌面>上的預留孔，鎖入B-1<M5*6mm螺絲>鎖緊固定。

Step 3 : Align ③ <Drawer> with the reserved holes on ① <Desk>, Screw B-1 <M5*6mm Screw>.

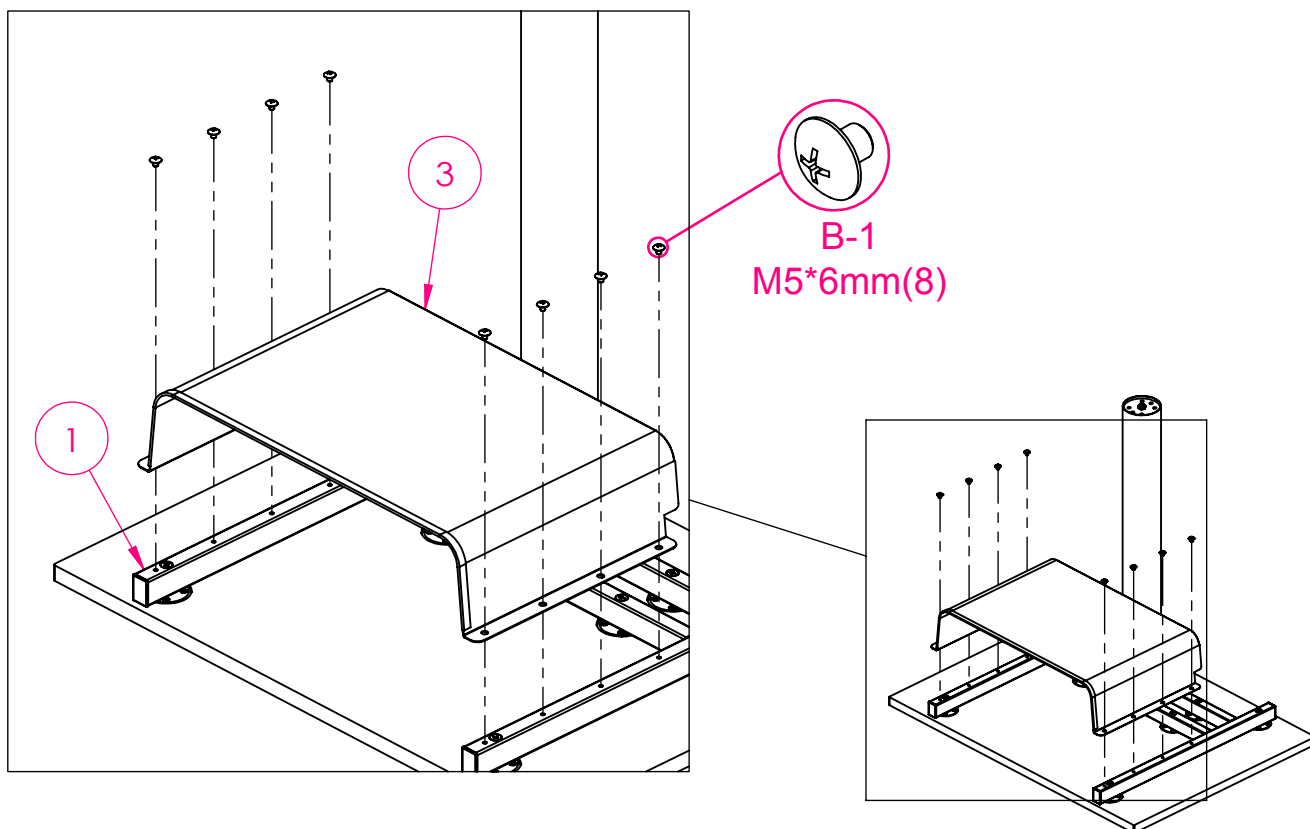

步驟四：將④<底座>對準②<立柱>尾端的預留孔位，使用C-2<5號六角扳手>鎖入C-1<M8*15mm螺絲>固定。

Step 4 : Align ④ <Base> with the reserved holes on ② <Column>, Use C-2 <5#Allen wrench> and screw C-1 <M8*15mm Screw>.

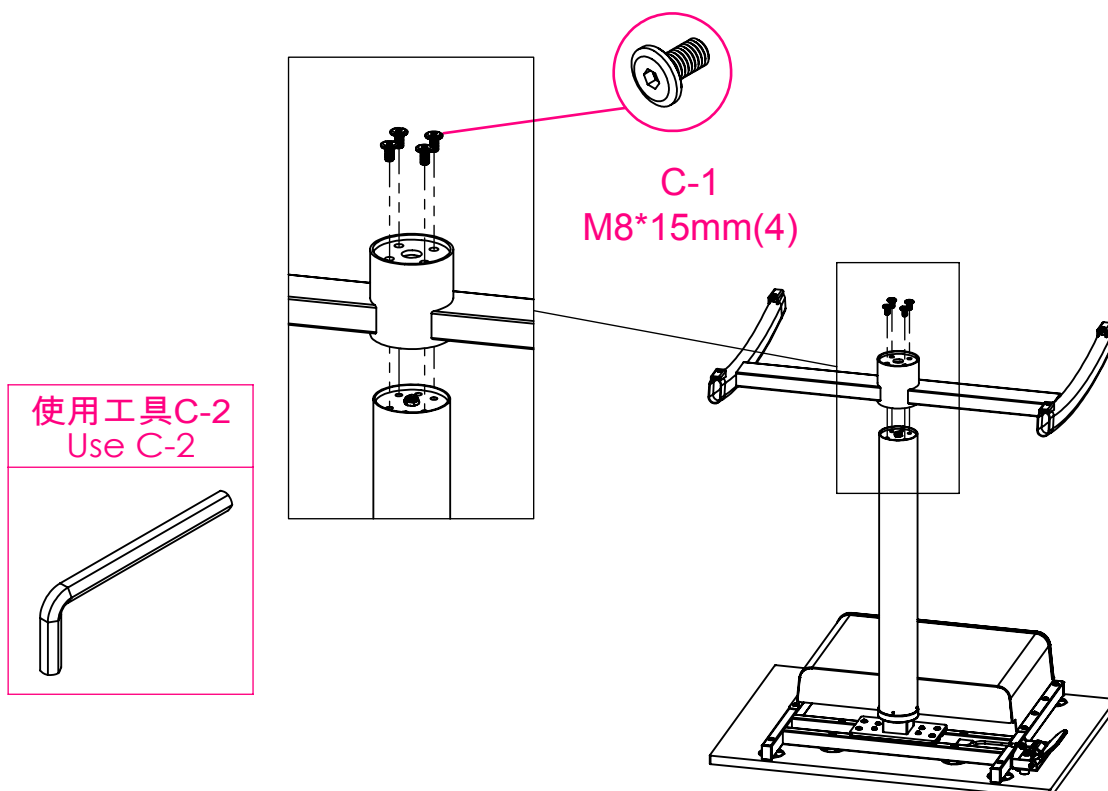

步驟五：將⑤<剎車輪>與⑥<活動輪>對準④<底座>的預留孔位，使用D-1<13號開口扳手>將其鎖緊固定。

Step 5 : Align the ⑤<Locking Casters> and ⑥<Casters> with the reserved holes in ④<base>, and use the D-1<13mm open-end wrench> to lock them in place.

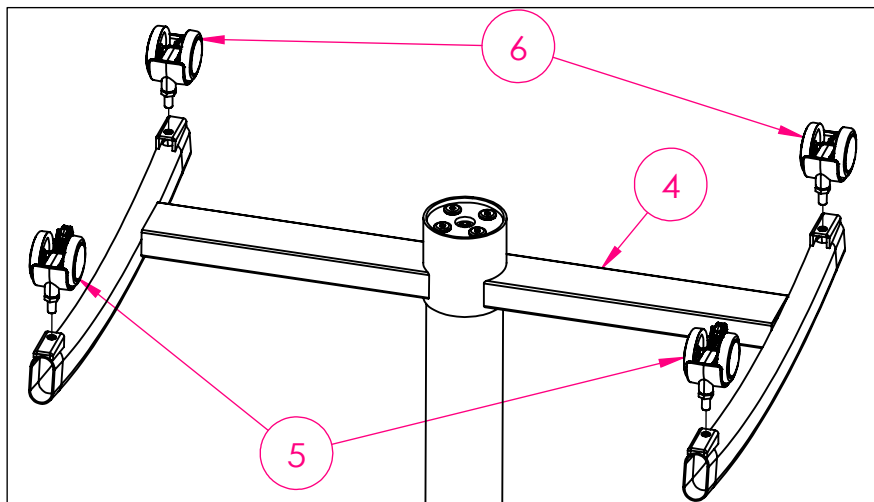

使用工具D-2
Use D-2

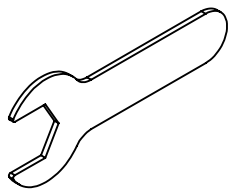

※建議※
將⑤<剎車輪>鎖在前端(底座長邊)，
⑥<活動輪>鎖在後端(底座短邊)。

※Recommendation※
Lock ⑤<Locking Casters> at the front (long edge of base),
⑥<Casters> at the back (short edge of base).

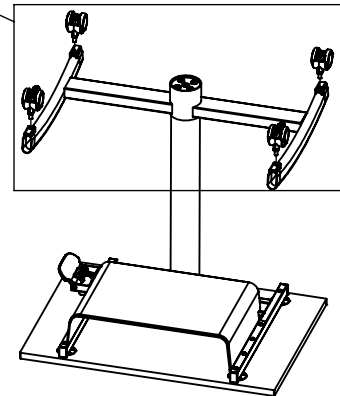

步驟六：將⑦<橡膠管塞>套入④<底座>。

Step 6 : Insert ⑦<Rubber Tube Caps> into ④<Base>.

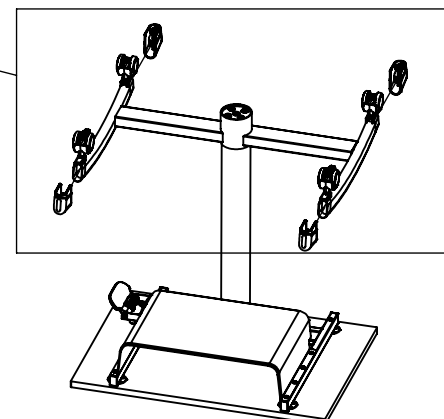
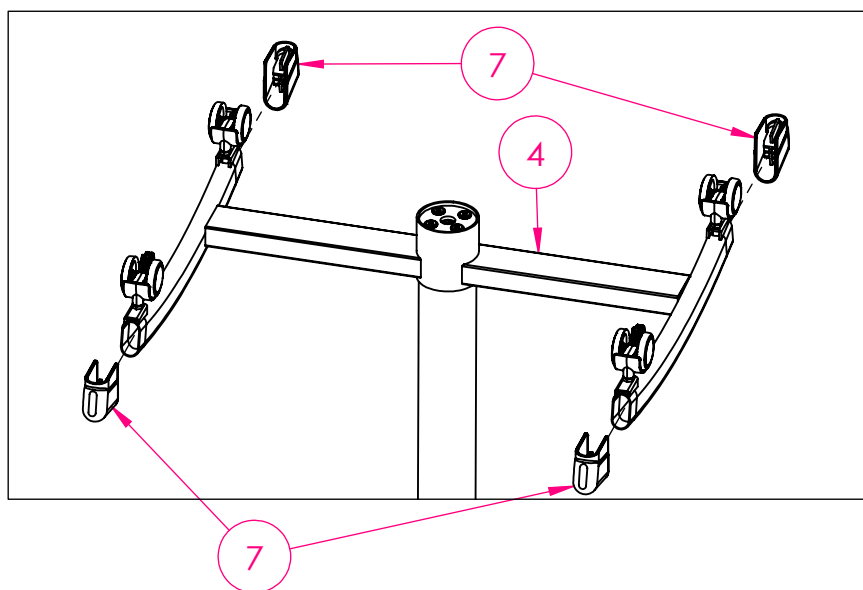

步驟七：將桌子翻面，完成組裝。

Step 7 : Turn the table upright and completed.

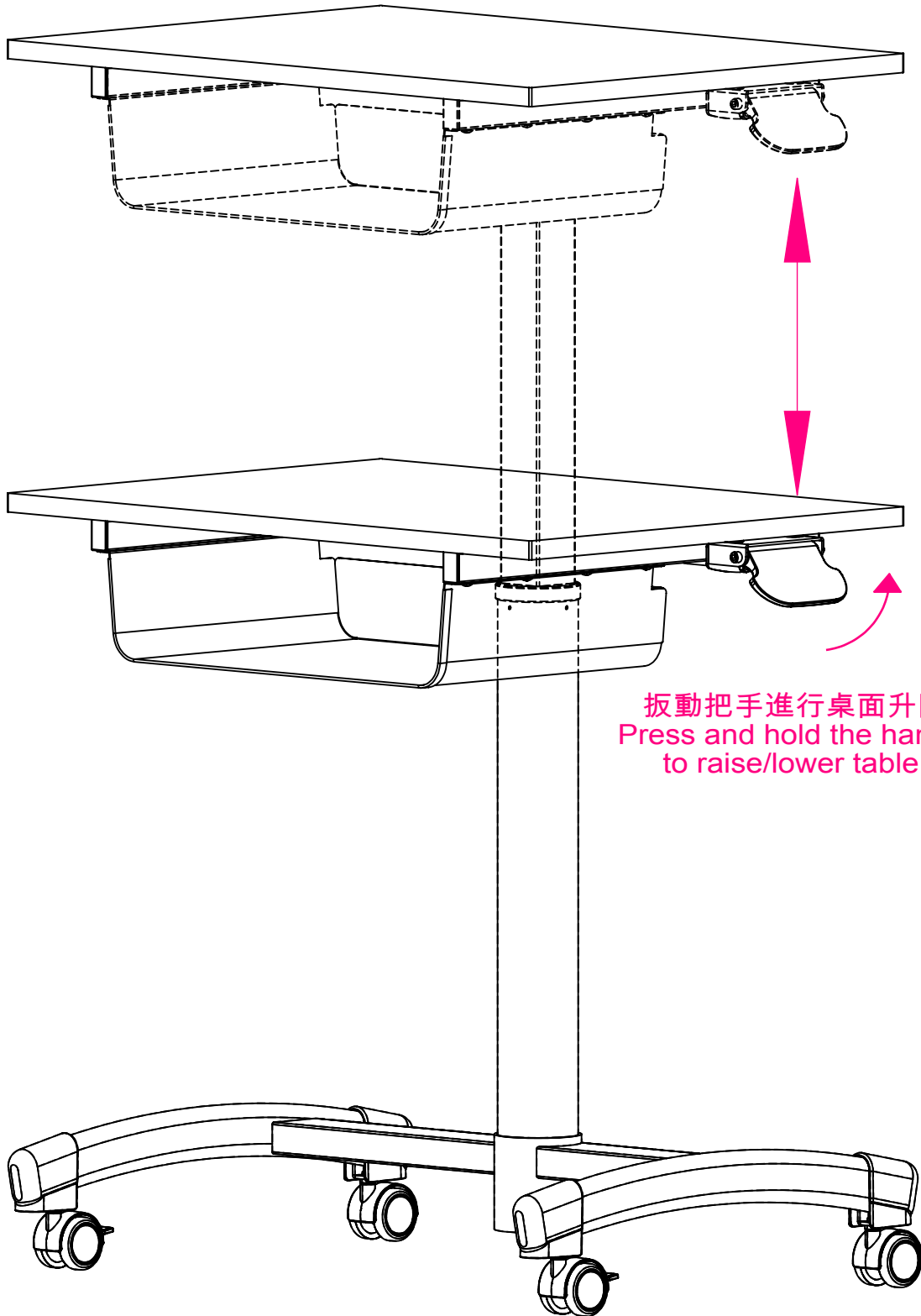

扳動把手進行桌面升降
Press and hold the handle
to raise/lower table.

程鼎實業股份有限公司
台灣台中市大雅區神林路一段526號
Tel:886-4-25679181 Fax:886-4-25669582
統一編號：80112978
Website: www.cdgreat-officefurniture.com

C.D. Great Furniture Co., Ltd.
No.526, Sec. 1, Shenlin Rd., Daya Dist., Taichung City 428, Taiwan.
Tel:886-4-25679181 Fax:886-4-25669582
Website : www.cdgreat-officefurniture.com